

# Rotary union

1 Channel

Typ DDF-1

## General data

<b>Pressure*:</b>	-0,9 bar / 16 bar on request: 40 bar
<b>Temperature*:</b>	0°C / +100°C enlarged temperature range on request
<b>Seal material:</b>	sealing channel: FKM / PTFE sealing connection: NBR other seal materials on request (e.g. FKM)

Art.-no.	Type	Channel	Flow (per channel)	Weight	Middle Torque**	Rotation* (rpm)
<b>ZK5490</b>	DDF-1-M5	<b>1</b>	150 l/min	0,08 kg	1 Nm	3000
<b>ZK5501</b>	DDF-1-1/8	<b>1</b>	600 l/min	0,21 kg	1 Nm	3000
<b>ZK5502</b>	DDF-1-1/4	<b>1</b>	1.300 l/min	0,32 kg	1 Nm	3000
<b>ZK5503</b>	DDF-1-1/2	<b>1</b>	3.500 l/min	0,64 kg	1 Nm	2000
<b>ZK5518</b>	DDF-1-3/4	<b>1</b>	14.000 l/min	1,65 kg	2 Nm	1500
<b>ZK5517</b>	DDF-1-1	<b>1</b>	20.000 l/min	2,56 kg	3 Nm	1200



All Rotary unions are available in stainless steel  
(Art.-No.... -H)

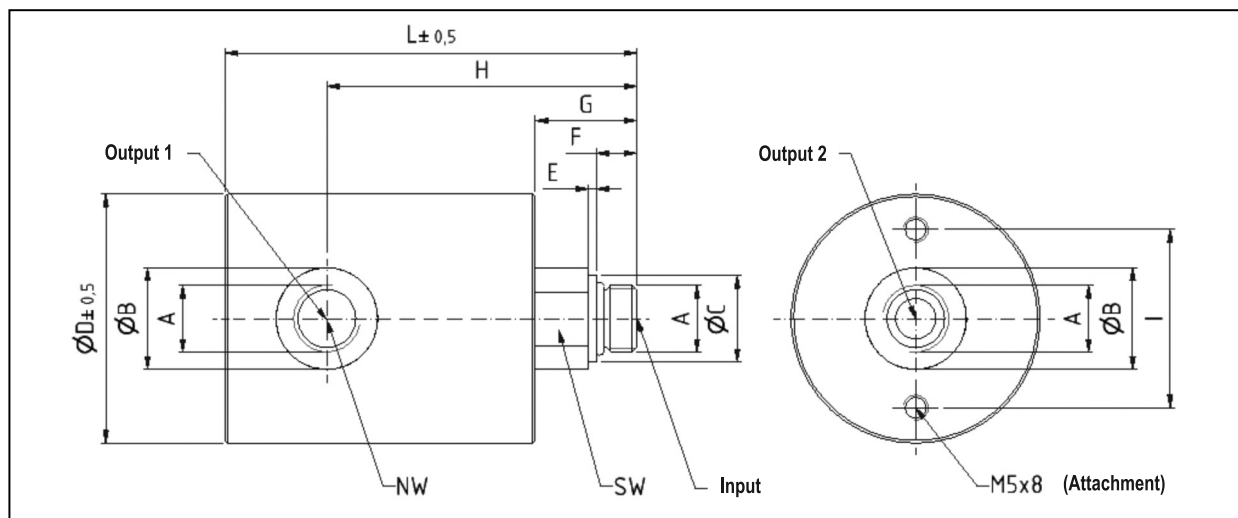

Art.-no.	A	B	C	D	E	F	G	H	I	L	NW	SW
<b>ZK5490</b>	M5	9	7,9	26	1,0	6,5	14,0	42,5	18	54,0	2,5	10
<b>ZK5501</b>	G1/8"	16	14,5	39	1,0	6,5	18,0	59,0	28	75,0	6,0	17
<b>ZK5502</b>	G1/4"	20	17,0	49	1,5	8,0	20,0	61,0	35	81,0	8,0	17
<b>ZK5503</b>	G1/2"	28	26,5	59	1,5	10,5	25,5	79,5	42	110,5	15,0	27
<b>ZK5518</b>	G3/4"	33	32,5	79	1,5	16,0	38,5	101,5	48	136,5	20,0	38
<b>ZK5517</b>	G1"	41	39,0	99	1,5	18,0	34,5	104,5	55	139,5	25,0	44

# Rotary unions

## General information

### Application

**Rotating unit distributors are used as a connection between stationary and rotating machinery elements.**

The DDF-1 series offers an optimum in flexibility for your installation, because of its radial and axial exit.

The multiple series offers the corresponding number of channels for the transmission of medium. Different or several media can be transmitted through the DDF (requires clarification with Konstandin GmbH).

### Assembly / Usage

The fastening bores of the rotating unit can be used to lock the unit against rotation, but they can not be used to tie it.

Fast oscillate motions (that means, changes in direction less than 2 sec.) are reducing the life time of about 50 %.

In order to avoid an overheating of the rotation unit ( $>80^{\circ}\text{C}$  /  $>100^{\circ}\text{C}$  – depending on version) the flow quantity of the medium has to be sufficient all time. At passage of different or several media through the DDF an outleak line will be necessary for security. Please contact our Technical Division. Special constructions are generally possible.

### Service

All rotating units are checked before shipment. This inspection ensures the faultless condition of the unit when receiving it, so that it can be installed on time.

Technical modifications reserved

## General information

Pressure*	-0,9 bar / 16 bar	
	on request:	40 bar DDF-1 100 bar DDF-multiple other pressure range
Temperature*	0°C / +100°C	
	0°C / + 80°C	
	enlarged temperature range on request	
Medium	compressed air, vacuum	
	on request:	hydraulic oil, water, other / different media
Filtering	liquid media:	5 µm
	gaseous media:	30 µm
Material	housing:	aluminium - red anodized optionally stainless steel (Art.-No.... -H)
	spindle:	stainless steel

### Warranty

Konstandin GmbH guarantees the faultless condition concerning material and fashioning of the delivered products. The warranty period and responsibility are established in legal rights.

We give a 6-month guarantee (from delivery) for sealing components and expendable parts when using the DDF due to our operating conditions.

The responsibility for resend rotation units is explicitly limited on replacement and repair of the unit or parts of it, which are definitely faulty.

Konstandin GmbH is not responsible for damaging after effects, which can result out the usage of such faulty elements.

The warranty goes out in case the rotating unit has been dismantled, changed or damaged because of improper treatment.

\* The given values are maximum values. With a combination of several parameters in the limit range technical advice is necessary. Please contact our Technical Department.

\*\* Middle torque, pressure-less, after 2-3 rotations. Break loose torque can be higher.